

RED ROOSTER POWER TOOLS

LEADING IN POWER TOOL SOLUTIONS

www.rami-yokota.com



Impact wrenches

Screwdrivers

Drills

Ratchet wrenches

Grinders

Sanders

Hammers

Needle scalers

Saws

Impact sockets

 **RED
ROOSTER**

CONTENTS

IMPACT WRENCHES.....	4
RATCHET WRENCHES.....	7
SCREWDRIVERS.....	8
DRILLS.....	10
GRINDERS.....	12
PALM ORBITAL SANDERS.....	15
MINI SANDERS.....	16
BELT SANDERS.....	16
HAMMERS.....	19
NEEDLE SCALERS.....	20
SAWS.....	21
VARIOUS TOOLS.....	23
IMPACT SOCKETS.....	25

HOW TO USE

Before using new air power tools, please check before connecting that the quick coupler and hose are clean and the hose is blown free of talcum (first use). Make sure that the compressed air is dry and clean (according to ISO 8573-1), for which we advise the use of SMC air treatment equipment and a correctly adjusted lubricator with the right oil. For RED ROOSTER air tools we recommend RED ROOSTER ATLUB oil, which is resin and acid free oil. To accomplish a good lubrication, we advise the use of a hose between lubricator and the air tool with a maximum length of 8 m (26ft). If this is not possible, contact us for a solution that will be applicable to your situation.

AIR PRESSURE AND QUALITY

RED ROOSTER air tools perform best at 6,3 Bar. When air pressure is lower, tool performance will decrease by up to 25% with 1 Bar pressure loss.

Low pressure may occur if:

- Capacity of the compressor is insufficient for type and amount of air tools in use
- Air tank is too small for the requested air flow
- The air piping diameter is too small
- Air leaks
- Incorrect size air nipples / quick couplers are being used
- Air treatment equipment is insufficient / not functioning properly

For a good quality compressed air, check your air treatment equipment and lubricators and make sure maintenance is performed on a regular basis

MAINTENANCE

Please check your air piping and compressor tank daily for water and check if lubricators are filled with RED ROOSTER ATLUB air tool oil. If lubricators stay full over a longer period of time, please check if they are set correctly to lubricate the air while tools are in use.

ECOLOGY

RED ROOSTER tools are innovatively designed, paying the highest attention to the environment and its safeguard. All the components are easy to dispose of, because they are built with recyclable materials. Therefore they do not present any danger in terms of environmental pollution. Models with automatic air shut-off reduce the cycle time and therefore the compressed air consumption.



PRODUCTIVITY!

Since its introduction in 1973, RED ROOSTER is one of the leading brands in the European market for pneumatic tools. RED ROOSTER is known for its reliable quality and provides you with a full range of power tools with excellent price - performance ratio. You can count on us when it comes to powerful, reliable and ergonomically designed tools. We do not only deliver the tools, we also advise on which tools work best for your situation and on air treatment. We have a professional workshop with a fully equipped test center and excellent logistics. From here we can take care of maintenance and service for all your RED ROOSTER tools to guarantee you optimal operational performance. RED ROOSTER have a range of high quality tools for industrial and assembly applications recognizable by a silver RED ROOSTER logo and a sturdy range of powerful service tools with a red RED ROOSTER logo. Together with our local partners RED ROOSTER guarantees: **PRODUCTIVITY!**

ACTION IMPACT SOCKETS



With ACTION impact sockets you work with the best. Manufactured from chrom-molybdenum alloy steel according to DIN 3121 and DIN 3129. Made to fit your tools with the lowest tolerance between impact socket and square drive and little play between the socket and the bolt. This result is lower vibration, less wear and a longer life of the tool and impact socket.

SMC AIR TREATMENT



Often the importance of compressed air quality for pneumatic tools is ignored, while low air quality leads to loss of performance and a lower life time of your air tools. For optimal performance of your air tools, compressed air needs to have the right pressure and needs to be clean and dry according to ISO 8573-1. SMC air treatment helps you to work effectively with air tools.

IMPACT WRENCHES



Applications

Nuts and bolts can get stuck due to corrosion etc. Fortunately the impact wrench can untighten any joint without problems and without any major effort from the operator. To the observer, the most common impact wrench used in garages are 1/2" square drive, and are suitable for nuts and bolts up to M14 - M16. On the other hand, if there is a lot of work to do repairing vans and larger vehicles, then you will come across bolt sizes of M22 - M24 and a 3/4" square drive should be used. The 1" square drive impact wrenches are usually used in truck and bus workshops. Besides (car)workshops, impact wrenches are also used in other industries, on shipyards, at construction workshops and in the petrochemical industry.

The right choice!

Most makes of impact wrenches look more or less the same. However the prices may differ. This is because of the quality of the impact mechanism. If the tool is only to be used once in a while, then it is advisable that you buy a cheaper model, if however the tool is going to be used more frequently then the industrial models are to be considered. Manufactured with stronger materials and better quality impact mechanisms, they guarantee a longer, more durable and trouble free lifetime. Cheaper tools are mostly executed with the single hammer impact mechanism. The industrial ones however, have a pin-clutch (Dynapact) or twin hammer system. Noise, vibration and weight also influence the price. An industrial wrench has a better silencer and less vibration. In tire workshops where impact wrenches are used continuously, these are the most important factors. Fortunately more and more impact wrenches are executed with a rear exhaust (outgoing airflow through the hand grip), while most of the conventional wrenches have an exhaust which is situated at the front of the tool. This can

cause brake dust to be blown into the face of the operator while untightening the wheel nuts. Very uncomfortable.

Torque

Often people think that the torque of an impact wrench is about the same as the performance of the tool. However it is incorrect to compare impact wrenches on torque figures alone, as there is no standard for measuring the torque. The specified torque is depending on various points: impact mechanism, weight, air consumption, quality.

Caution when tightening!

Impact wrenches were designed for untighten fixed joints. In practice they are also often used for the tightening nuts and bolts, but beware! Impact wrenches are, for example, a killer of soft joints. Because of the speed of the tool, the required torque will have been hit and over tightened very quickly. This could have serious consequences when it comes to the legal product liability regulations and the ISO certification. The tightening of nuts and bolts should be done by torque adjustable tools (see our impulse wrenches).

Please note

When using impact wrenches and impulse wrenches, the torques shown will vary if used on a soft joint, e.g. washers, gaskets, etc.

IMPACT WRENCHES



RRI-14
MAX. 610 Nm³⁾



RRI-17
MAX. 680 Nm³⁾



RRI-21
MAX. 1.750 Nm³⁾



RRI-25
MAX. 2.550 Nm³⁾



RR-16N



RR-16N T



RR-18N



RR-18N T³⁾



RR-24N



RR-160H



RR-15A

Type	Brand	Square drive	Type ⁶⁾	Bolt capacity mm	Impact-mechanism	RPM	Torque Nm	Power adjustment ¹⁾	Air cons. l/s	Weight kg	Inlet-thread	Hose-diameter mm	Vibration m/s ²	Noise level dB(A)
RRI-14 ³⁾	RRI	1/2"	R	14	Twin-Hammer	9.000	440	R 2 levels	5,3	1,1	PT 1/4"	6,5	5,8	89
RR-16N 3/8	RR	3/8"	R	12	Twin-Hammer	11.000	340	R 3 levels	5	1,3	PT 1/4"	6,5	4,6	83
RR-16N 1/2	RR	1/2"	R	14	Twin-Hammer	11.000	405	R 3 levels	5	1,2	PT 1/4"	6,5	4,6	83
RR-16N T ²⁾	RR	1/2"	R	14	Twin-Hammer	11.000	405	90 Nm	5	1,2	PT 1/4"	6,5	4,6	83
RRI-17 3/8 ³⁾	RR	3/8"	R	16	Twin-Hammer	10.000	390	R 3 levels	5,5	1,3	PT 1/4"	10	6,8	89
RRI-17 1/2 ³⁾	RRI	1/2"	R	16	Twin-Hammer	10.000	450	R 3 levels	5,5	1,3	PT 1/4"	10	6,8	89
RR-18N	RR	1/2"	R	16	Twin-Hammer	7.000	815	R 3 levels	8,2	2	PT 1/4"	10	4,8	83
RR-18N T ²⁾	RR	1/2"	R	16	Twin-Hammer	7.000	815	90 Nm	8,2	2	PT 1/4"	10	3,1	83
RRI-21 ³⁾	RRI	1/2"	R	20	Twin-Hammer	7.500	900	R 3 levels	9,2	2	PT 1/4"	10	3,4	86
RR-24N	RR	3/4"	R+H	24	Twin-Hammer	5.500	1.625	R 3 levels	9,1	3,4	PT 3/8"	10	4,8	90
RR-24N 1	RR	1"	R+H	24	Twin-Hammer	5.500	1.900	R 3 levels	9,1	3,7	PT 3/8"	10	4,8	90
RRI-25 ³⁾	RRI	3/4"	R	24	Twin-Hammer	5.000	1.800	R 3 levels	9,8	3,7	PT 3/8"	10	7,6	87
RR-160H	RR	1/2"	R	16	Dynapact	8.000	580	R/L 4 levels	8	2,3	PT 1/4"	10	11	82
RR-15A	RR	1/2"	R	14	Jumbo-Hammer	7.000	270	R 2 levels	5,3	1,8	PT 3/8"	9,5	5,8	89

¹⁾ All impact wrenches are right and left turning / "R 3 levels" means: 3 positions clockwise and counterclockwise full power

²⁾ RR-16N T & RR-18N T: maximum tightening torque: 90 Nm, full power in untightening

³⁾ Breakloose torque RRI-14: 610 Nm, RRI-17: 680Nm, RRI-21: 1.750 Nm, RRI-25: 2.550 Nm

⁶⁾ Type: H = Hole type, R + H = Ring + Hole Type

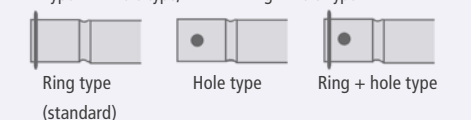

IMPACT WRENCHES



Type	Brand	Square drive	Type ¹⁾	Bolt capacity mm	Impact-mechanism	RPM	Torque Nm	Power adjustment	Air cons. l/s ⁴⁾	Weight kg	Inlet-thread	Hose-diameter mm	Vibration m/s ²	Noise level dB(A)
RR-37E *	RRI	1"	R+H	36	Twin-Hammer	6.000	2.200	R/L 3 levels	15	8,75	PT 1/2"	13	17	99

* also available with short spindle upon request

IMPACT WRENCHES SETS



RR-18N/SETSTD

- impact wrench RR-18N
- 5 x 1/2" impact sockets (SW 17-19-21-22-24)
- 1 x extension bar 100 mm
- blow mold case



RR-18N/SETLNG

- impact wrench RR-18N
- 5 x 1/2" impact sockets (SW 17-19-21-22-24 deep)
- 1 x extension bar 100 mm
- blow mold case

DIMENSION

Type	A mm	A* mm	B mm
RR-15A	340	-	32
RR-16N	150	-	30
RR-16NT	150	-	30
RR-18N	185	-	30
RR-18NT	185	-	30
RR-24N	210	-	50
RR-160H	185	-	30
RRI-14	120	-	32
RRI-17	172	-	29
RRI-21	190	-	35
RRI-25	234	-	43
RRI-37E	-	515	52

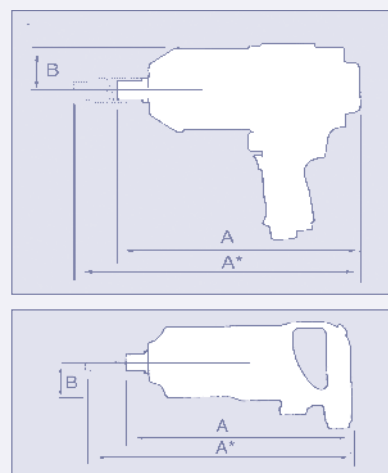

SPARE PARTS

Spring ring for impact sockets

Type	Spring ring	O-Ring
RR-16N/18N(T)	40303	13-11-05-006
RRI-21	250-033	00-4103
RR-24N	45-405112	OR01000305
RR-160H	250-033	00-4103
RRI-17 3/8"	242-026	00-4144
RRI-17 1/2"	250-033	00-4103
RRI-25	280-028	00-4175

ACCESSORIES



Exhaust hose assembly

Order number	For type
EH-43-4033SUB	RR-16N/18N/18NT
EH-454051P	RR-24N

RATCHET WRENCHES



RATCHET WRENCHES - 1/4" + 3/8" + 1/2" SQUARE DRIVE



RRW-2202/03



RRW-2403/04



RRW-121

Type	Brand	Square-drive	Bolt capacity mm	RPM	Torque Nm	Air cons. l/s	Weight kg	Inlet-thread	Hose-diameter mm	Vibration m/s ²	Noise-level dB(A)
RRW-2202	RR	1/4"	8	270	32	5,0	0,5	PT 1/4"	6,5	4,3	85
RRW-2203	RR	3/8"	10	270	32	5,0	0,5	PT 1/4"	6,5	4,3	85
RRW-2403	RR	3/8"	12	150	68	6,0	1,2	PT 1/4"	6,5	5,8	85
RRW-2404	RR	1/2"	12	150	68	6,0	1,2	PT 1/4"	6,5	5,8	85
RRW-121	RR	1/2"	12	135	120	8,0	1,9	PT 1/4"	10	2,3	88

RATCHET WRENCHES - REACTIONLESS



RRW-3403/04

Type	Brand	Square-drive	Bolt capacity mm	RPM	Torque Nm	Air cons. l/s	Weight kg	Inlet-thread	Hose-diameter mm	Vibration m/s ²	Noise-level dB(A)
RRW-3403	RR	3/8"	12	500	95	6,0	1,28	PT 1/4"	6,5	4,5	91
RRW-3404	RR	1/2"	12	500	95	6,0	1,28	PT 1/4"	6,5	4,5	91

DIMENSIONS

Type	A mm	B mm
RRW-121	357	57
RRW-2202 /RRW-2203	180	32
RRW-2403	250	40
RRW-2404	250	45
RRW-3403	280	40
RRW-3404	280	45

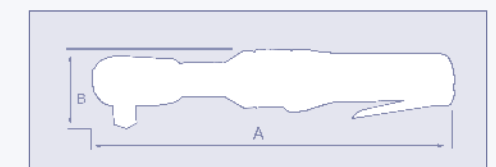

SCREWDRIVERS

DIMENSIONS

Type	A mm	B mm	C mm
RR-02SP / RRI-06SP	214	-	165
RR-06SC	227	150	155
RR-02SC	260	50	-
RR-0800DD	190	-	165
RR-1800DD	175	-	165

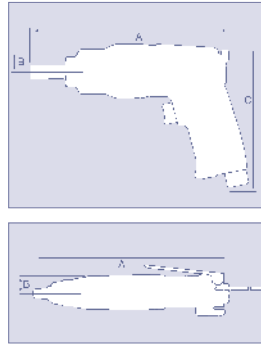

CONTROL

Direct drive

RR-0800DD	Trigger start
RR-1800DD	Trigger start

Slip clutch (adjustable)

RR-02SP/RR-06SP	Trigger start
RR-02SC/RR-06SC	Lever start

ACCESSORIES

Side handles

Type	Bestelnummer
RR-06SP	* 75-725139-00015 +822340

* Standaard meegeleverd

Hose set noise suppressor

Type	Bestelnummer
RR-0800DD RR-1800DD RR-02SP RR-06SP	EH-701SUB



Torque springs

Automotive models RR-02SP/SC and RR-06SP/SC are supplied with 2 torque springs.

Spring balancers

The performance of the tool will be increased by good balance and reduced operator fatigue, when using a spring balancer.

SELECTION GUIDE

What to choose

Type	Machine screw 4.8	Machine screw 8.8	Self tapping screw-M	Self tapping screw-ST	Self tapping screw-ST, for plastic	Self-drilling/ Self-tapping screw-S	Wood screw
Impact	Green	Green	Green	Green	Red	Green	Green
Direct drive	Green	Green	Green	Green	Red	Green	Green
Clutch type mechanism	Green	Green	Green	Green	Red	Green	Green
Shut-off mechanism	Green	Green	Green	Green	Red	Green	Green

Green recommended Orange OK Red not OK

SCREWDRIVERS

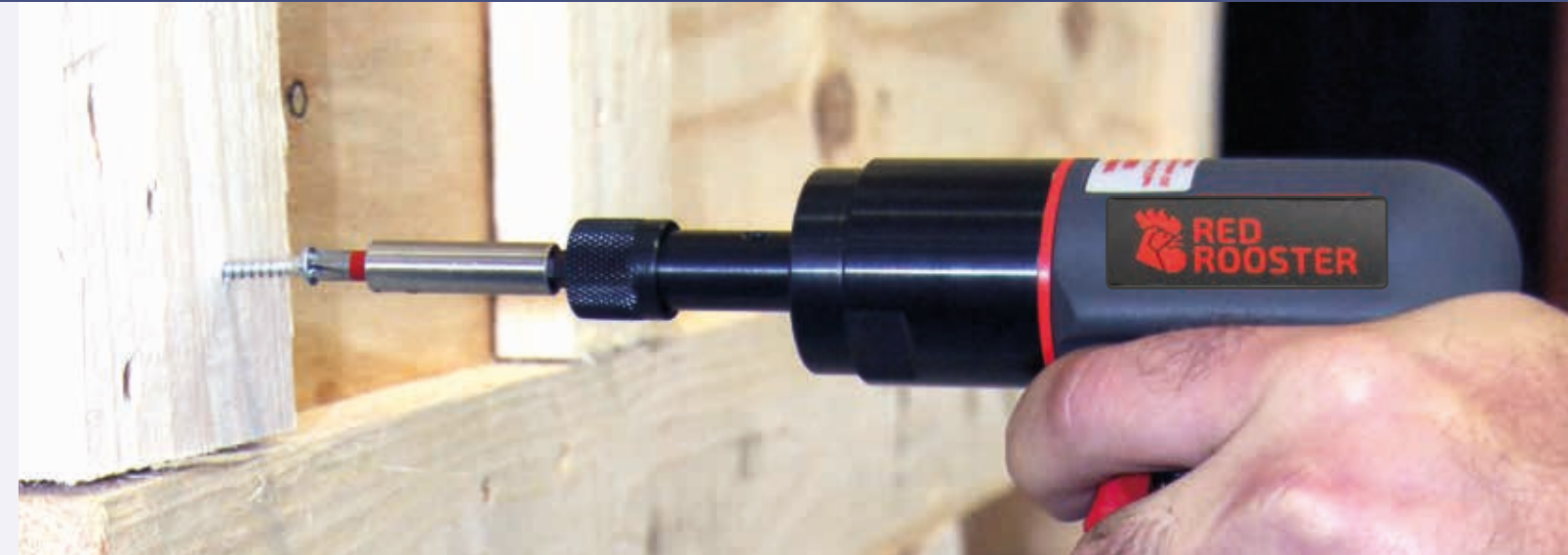

SCREWDRIVERS CLUTCH TYPE MECHANISM (ADJUSTABLE)



RR-02SC



RR-06SC



RR-02SP



RR-06SP

Type	Brand	Square hex drive	Bolt capacity mm	Model	RPM	Torque Nm	Air cons. l/s	Weight kg	Inlet-thread	Hose-diameter mm	Vibration m/s ²	Noise-level dB(A)
RR-02SC	RR	1/4" hex	5	Straight	1.800	1 - 6	10,0	1,2	PT 1/4"	10	1,6	85
RR-06SC	RR	1/4" hex	6	Straight	800	5 - 16	10,0	1,4	PT 1/4"	10	1,6	85
RR-02SP	RR	1/4" hex	5	Pistol	1.800	1 - 6	10,0	1,3	PT 1/4"	10	1,6	85
RR-06SP	RR	1/4" hex	6	Pistol	800	5 - 16	10,0	1,4	PT 1/4"	10	3,5	83

SCREWDRIVERS DIRECT DRIVE



RR-0800DD



RR-1800DD

Type	Brand	Hex drive	Bolt capacity mm	Model	RPM	Torque Nm	Air cons. l/s	Weight kg	Inlet-thread	Hose-diameter mm	Vibration m/s ²	Noise level dB(A)
RR-0800DD	RR	1/4" hex	6	Pistol	800	10,5	9,8	1,0	PT 1/4"	10	3,5	83
RR-1800DD	RR	1/4" hex	6	Pistol	1.800	7,5	9,8	1,0	PT 1/4"	10	3,5	83

DRILLS

DIMENSIONS

Type	A mm	B mm	C mm
RR-10DP	185	165	-
RR-13DP	218	165	-
10RDS-2500	250	-	22
10RDS-4000	250	-	25
RRI-2006	192	138	14
RRI-2206/28	128	116	14
RRI-2206/40	128	116	14
RRI-2116P	270	168	28

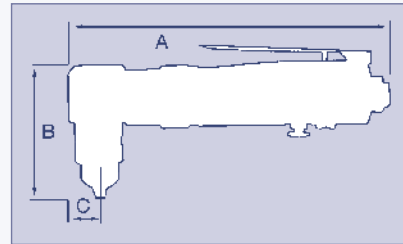
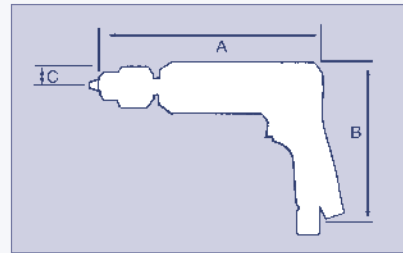

ACCESSORIES

Drill chucks

Type		Order number
RRI-2206/28	*	6MM-3/8 x 24NF
RRI-2206/40	*	6MM-3/8 x 24NF
RRI-2006	*	6MM-3/8 x 24NF
RRI-2116P	*	BHP-16 1/2 x 20NF
10RDS-4000	*	10MM-3/8 x 24NF

* Supplied as standard

Quickchange drill chucks

Type		Order number
RR-10DP	*	10035-14
10RDS-2500	*	10035-14
RR-13DP	*	10033-14

* Supplied as standard

Side handles

Type		Order number
RR-13DP	*	822340 + 75-725139-0001S
RRI-2116P	*	2116-061-99

* Supplied as standard

Keys for drill chucks

Type		Order number
RRI-2116P	*	90200
RRI-2206/28	*	90160
RRI-2206/40	*	90160

* Supplied as standard

DRILLS



DRILLS - PISTOL & STRAIGHT MODELS



RRI-2006



RRI-2206/28
RRI-2206/40



RR-10DP



RRI-2116P



RR-13DP



10RDS-2500

Type	Brand	Capacity steel mm	Spindle size	Rotation direction	RPM	Power kW	Air cons. l/s	Weight kg	Inlet-thread	Hose diameter mm	Vibration m/s ²	Noise level dB(A)
RRI-2006	RRI	6,5	3/8" x 24 UNF	R	5.000	0,21	10,8	0,65	PT 1/4"	10	3	79
RRI-2206/28	RRI	6,5	3/8" x 24 UNF	R	2.800	0,26	7,6	0,60	PT 1/4"	10	0,4	84
RRI-2206/40	RRI	6,5	3/8" x 24 UNF	R	4.000	0,26	7,6	0,60	PT 1/4"	10	0,6	86
RR-10DP ¹⁾	RR	10	3/8" x 24 UNF	L/R	1.800	0,35	8	1,1	PT 1/4"	10	4	83
RR-13DP ¹⁾	RR	13	3/8" x 24 UNF	L/R	800	0,35	8	1,3	PT 1/4"	10	4	83
10RDS-2500 ²⁾	RR	10	3/8" x 24 UNF	R	2.500	0,37	3,5	1,1	PT 1/4"	6,5	0,4	79
10RDS-4000 ²⁾	RR	10	3/8" x 24 UNF	R	4.000	0,37	3,5	1,1	PT 1/4"	6,5	0,4	79
RRI-2116P ^{3) 4)}	RRI	16	1/2" x 24 UNF	R	950 ⁴⁾	0,50	11	2,4	PT 1/4"	10	1,8	82

¹⁾ Gears with needle bearings / ²⁾ Straight model / ³⁾ Supplied with exhaust hose / ⁴⁾ Min. 650 p/min - Max. 950 p/min.



10RDS-4000



GRINDERS



Type	Brand	Wheel size mm	RPM	Power kW	Spindle (Whitworth) mm	Air cons. l/s	Weight kg	Inlet-thread	Hose diameter mm	Vibration m/s ²	Noise level dB(A)
RRG-1040AL	RR	100 x 1 x 9,6	14.000	0,76	M6	11	1,7	PT 1/4"	10	2,5	83
RRG-2034*	RR	100 x 6 x 16	12.000	0,45	M10	11	1,55	PT 1/4"	10	2,3	83
RRG-2044*	RR	115 x 6 x 22	12.000	0,45	M14x2	11	1,60	PT 1/4"	10	2,4	83
RRG-2055*	RR	125 x 6 x 22	12.000	0,45	M14x2	11,0	1,60	PT 1/4"	10	2,4	83
RRI-G50*	RRI	125 x 6 x 22	12.000	1,25	M14x2	22	1,8	PT 1/4"	13	<2,5	83
RRI-G70*	RRI	180 x (3-8) x 22	8.500	2	M14x2	33	4,1	PT 3/8"	16	2,4	83

* Vibration reduced The transfer of vibration to the user is greatly limited by the solid performance of the rubber handle.



Type	Brand	Wheel size mm	RPM	Power kW	Spindle (Whitworth) mm	Air cons. l/s	Weight kg	Inlet-thread	Hose diameter mm	Vibration m/s ²	Noise level dB(A)
RRG-1040AL	RR	100 x 1 x 9,6	14.000	0,76	M6	11	1,7	PT 1/4"	10	2,5	83

ACCESSORIES

Standard flanges and outer wheel screws

Type	Order number	Description
RRI-G70	G70-0531-99	Disc 175 x 22 mm Paper 180 x 22 mm

Standard flanges and outer wheel screws

Type	Order number	Description
RRG-2034	61938A 61940A	* Inner flange * Outer flange
RRG-2044 RRG-2055	5D-619239 5D-619240	* Inner flange * Outer flange

* Supplied as standard

M14x2 Quick nut

Type	Order number
RRG-2034 RRG-2044 RRG-2055	QN-M14

RRG-2034/2044/2055 are supplied with flanges for wheel thickness of 0,8 - 6 mm.

Flanges for cup wheels and a tool service set for mounting the flanges are supplied with all grinders.

GRINDERS



RRG-200RE / RRG-500RE

RRG-200REL / RRG-500REL

RRG-202T



RRG-1000RE

RRG-1000REL

RRG-2090



RRI-3425L / RRI-3425EL

RRI-3425

RRI-34100



RRI-3445

RRI-3407

RRI-3430

Type	Brand	Wheel size mm	RPM	Power kW	Collet chuck mm	Air cons. l/s	Weight kg	Inlet-thread	Hose diameter mm	Vibration m/s ²	Noise level dB(A)
RRI-34100	RRI	6	100.000	0,09	3	3,3	0,20	PT 1/4"	6,5	<2,5	73
RRI-3445	RRI	20	45.000	0,30	3 / 6	7,5	0,40	PT 1/4"	10	2,4	79
RRI-3430	RRI	20	30.000	0,23	3 / 6	7,5	0,40	PT 1/4"	10	2,2	81
RRG-200RE	RR	35	25.000	0,25	6	4	0,56	PT 1/4"	6,5	2,5	83
RRG-200REL	RR	35	25.000	0,25	6	4	0,86	PT 1/4"	6,5	1,5	83
RRG-500RE	RR	35	20.000	0,37	6	4,6	0,7	PT 1/4"	6,5	1,68	79
RRG-500REL	RR	35	20.000	0,37	6	4,6	1,4	PT 1/4"	6,5	1,68	79
RRG-1000RE	RR	35	22.000	0,74	6 (8) ²⁾	11	1,8	PT 1/4"	10	2,9	89
RRG-1000REL	RR	35	22.000	0,74	6 (8) ²⁾	11	2,6	PT 1/4"	10	2,9	89
RRI-3425	RRI	35	25.000	0,50	3 / 6	12,3	0,8	PT 1/4"	10	2	80,2
RRI-3425L	RRI	35	20.000	0,50	3 / 6	12,3	0,8	PT 1/4"	10	2,5	80,2
RRI-3425EL	RRI	35	20.000	0,50	3 / 6	12,3	0,95	PT 1/4"	10	2,5	80,6
RRI-3407	RRI	35	7.000	0,70	6 (8) ³⁾	4	1,15	PT 1/4"	6,5	<2,5	84
RRG-202T ¹⁾	RR	80	2.500	0,30	7/16" 6K	4	1,1	PT 1/4"	6,5	2	84
RRG-2090	RR	35	20.000	0,23	6	4,0	0,56	PT 1/4"	6,5	2,4	84

¹⁾ Tire buffer / ²⁾ 8 mm collet chuck also available: 50-500228-18 / ³⁾ 8 mm collet chuck also available: 315073

Shaft length: RRG-200REL: 116 mm / RRG-500REL: 180 mm / RRI-3425: 30 mm / RRI-3425L: 130 mm / RRI-3425EL: 215 mm

Note: RRG-200RE is also available in set (including assortment abrasives).

Collet chucks for die grinders are supplied with the tool.

GRINDERS

Die grinder sets



RRI-3007 / RRI-3006



RRG-200RE/SET

Type	Brand	Wheel size mm	RPM	Power kW	Collet chuck mm	Air cons. l/s	Weight kg	Inlet-thread	Hose diameter mm	Vibration m/s ²	Noise level dB(A)
RRI-3007	RRI	9	70.000	0,08	3	1,6	0,35	PT 1/4"	6,5	1,2	77
RRI-3006	RRI	12	58.000	0,10	3	1,6	0,35	PT 1/4"	6,5	0,8	80

ACCESSORIES

Adapters



Type	Order number	Description
RRG-500RE(L) RRG-200RE(L)	1001-0659-00-01	3 mm for 6 mm collet chuck

Exhaust hose / silencer kit



Type	Order number
RRG-2034 RRG-2044 RRG-2055	5D-619249

Collet chucks



Type	Order number	Description
RRG-200RE(L)	51224	* 6 mm
RRG-1000RE(L)	50-500228-18	8 mm

* Supplied as standard

DIMENSIONS

Type	A mm	B mm	C mm	D mm	E mm	Drawing
RRG-200RE	162	40	18	30	34	A
RRG-200REL	258	40	18	116	135	A
RRG-202T	233	44	31	52	92	A
RRG-500RE	190	45	22	30	-	A
RRG-500REL	350	45	22	180	190	A
RRG-1000RE	200	46	21	41	50	A
RRG-1000REL	330	46	21	171	50	A
RRG-1040AL	377	42	22	45	-	B
RRG-2034	215	95	25	50	-	B
RRG-2044	215	95	25	50	-	B
RRG-2055	215	95	25	50	-	B
RRG-2090	167	75	-	42	-	C

Type	A mm	B mm	C mm	D mm	E mm	Drawing
RRI-3006	151	16	10	-	-	A
RRI-3007	151	16	10	-	-	A
RRI-3407	280	45	28	38	80	A
RRI-3425	215	40	12	30	43	A
RRI-3425L	310	40	12	130	130	A
RRI-3425EL	390	40	12	215	215	A
RRI-3430	190	34	14	16	22	A
RRI-3445	190	34	14	16	22	A
RRI-34100	140	29	10	15	21	A
RRI-3506	150	80	-	40	-	C
RRI-G50	255	55	32	45	-	B
RRI-G70	351	110	45	-	-	B

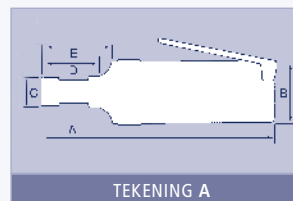

TEKENING A

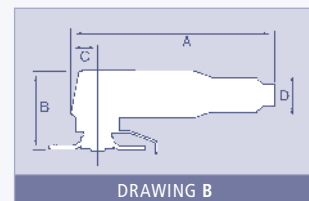

DRAWING B

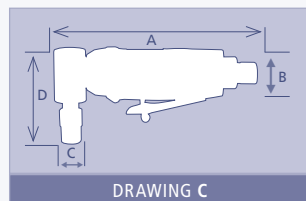

DRAWING C

PALM ORBITAL SANDERS



RRI-5125-2CV
RRI-5125-5CV
RRI-6150-2CV
RRI-6150-5CV



RRI-6150-2SV
RRI-6150-5SV
RRI-5125-2SV
RRI-5125-5SV



RRI-5125-2NV
RRI-5125-5NV
RRI-6150-2NV
RRI-6150-5NV



RRI-T6250-5NV
RRI-T6250-5CV

Type	Brand	Pad size mm	Stroke mm	RPM	Power kW	Spindle	Air cons. l/s	Weight kg	Inlet-thread	Hose diameter mm	Vibration m/s ²	Noise level dB(A)
RRI-5125-2NV ¹⁾	RRI	125	2,5	12.000	0,3	5/16" UNF	4,9	0,6	PT 1/4"	6,5	<2,5	73
RRI-5125-2CV ¹⁾	RRI	125	2,5	12.000	0,3	5/16" UNF	4,9	0,7	PT 1/4"	6,5	<2,5	73
RRI-5125-2SV ¹⁾	RRI	125	2,5	12.000	0,3	5/16" UNF	4,9	0,7	PT 1/4"	6,5	<2,5	73
RRI-5125-5NV ¹⁾	RRI	125	5	12.000	0,3	5/16" UNF	4,9	0,6	PT 1/4"	6,5	<2,5	73
RRI-5125-5CV ¹⁾	RRI	125	5	12.000	0,3	5/16" UNF	4,9	0,7	PT 1/4"	6,5	<2,5	73
RRI-5125-5SV ¹⁾	RRI	125	5	12.000	0,3	5/16" UNF	4,9	0,7	PT 1/4"	6,5	<2,5	73
RRI-6150-2NV ¹⁾	RRI	150	2,5	12.000	0,3	5/16" UNF	4,9	0,6	PT 1/4"	6,5	<2,5	73
RRI-6150-2CV ¹⁾	RRI	150	2,5	12.000	0,3	5/16" UNF	4,9	0,7	PT 1/4"	6,5	<2,5	73
RRI-6150-2SV ¹⁾	RRI	150	2,5	12.000	0,3	5/16" UNF	4,9	0,7	PT 1/4"	6,5	<2,5	73
RRI-6150-5NV ¹⁾	RRI	150	5	12.000	0,3	5/16" UNF	4,9	0,6	PT 1/4"	6,5	<2,5	73
RRI-6150-5CV ¹⁾	RRI	150	5	12.000	0,3	5/16" UNF	4,9	0,7	PT 1/4"	6,5	<2,5	73
RRI-6150-5SV ¹⁾	RRI	150	5	12.000	0,3	5/16" UNF	4,9	0,7	PT 1/4"	6,5	<2,5	73
RRI-T6250-5NV ¹⁾	RRI	150	5	12.000	0,3	5/16" UNF	4,9	1	PT 1/4"	6,5	3,65	73
RRI-T6250-5CV ¹⁾	RRI	150	5	12.000	0,3	5/16" UNF	4,9	1	PT 1/4"	6,5	3,65	73

¹⁾ Standard delivered with Hook & Loop. **NV** = No dust extraction / **CV** = For connection to central dust extraction / **SV** = Self created Vacuum for dust extraction

MINI SANDERS

Mini sanders



RRS-60152K



RRS-60152

RRS-60153K

Mini polisher

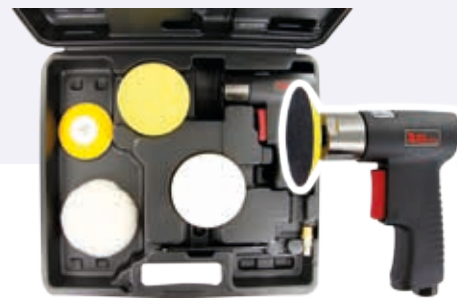

RRS-60153

RRS-60323K

RRS-60323

Type	Brand	Pad size mm	RPM	Power kW	Air cons. l/s	Weight kg	Inlet-thread	Hose-diameter mm	Vibration m/s ²	Noise level dB(A)
RRS-60152 ¹⁾	RR	50	15.000	0,3	4,9	0,54	PT 1/4"	10	0,74	80
RRS-60153 ²⁾	RR	75	15.000	0,3	4,9	0,54	PT 1/4"	10	0,74	80
RRS-60323 ³⁾	RR	75	3.200	0,3	4,9	0,75	PT 1/4"	10	0,74	80

¹⁾ RRS-60152 = mini sander Ø50 mm (Roloc™-Pad) / ²⁾ RRS-60153 = mini sander Ø75 mm (Roloc™-Pad) / ³⁾ RRS-60323 = mini polisher Ø75 mm (Velcro Pad)

The RRS mini sanders can be ordered as separate tool or as set (K) with sanding and/or polishing discs.

The mini sanders RRS-60152K and RRS-60153K come in a plastic case containing the following sanding pads: 10 x grain 80, 10 x grain 100 and 10 x grain 120. The RRS-60323K comes with 2 polishing pads and 1 polishing bonnet.

The ROLOC™ system ensures quick and save changing of the pads.

ACCESSORIES

Sanding pads

Sanding pads	Order number	Description
RRI-5125-2NV RRI-5125-5NV	65-613342*	Multi hole pad 125 mm
RRI-5125-2CV RRI-5125-5CV RRI-5125-2SV RRI-5125-5SV	65-613342* OPTIONELL 50LVJOSY-P	Multi hole pad 125 mm Pad 125 mm, multi hole
RRI-6150-2NV RRI-6150-5NV RRI-T6250-5NV	610227V-61*	Multi hole pad 150 mm
RRI-6150-2CV RRI-6150-5CV RRI-6150-2SV RRI-6150-5SV RRI-T6250-5CV	66-613A43	Multi hole pad 125 mm 15 holes

* Supplied as standard

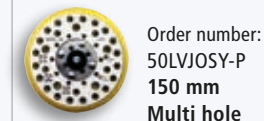
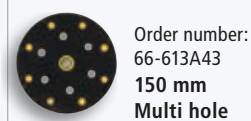

ACCESSORIES

Sanding pads

Type	Order number	Description
RRS-60152	600125-21	Roloc™-Pad, Ø 50 mm
RRS-60153	600127-31	Roloc™-Pad, Ø 75 mm
RRS-60323	6004-031-00	Hook & Loop-disc, Ø 75 mm

DIMENSIONS

Type	A mm	B mm
RRI-5125-2NV/5NV	163	104
RRI-6150-2NV/5NV	163	104
RRI-5125-2CV/5CV	213	104
RRI-6150-2CV/5CV	213	104
RRI-5125-2SV/5SV	213	104
RRI-6150-2SV/5SV	213	104
RRI-T6250-5NV/5CV	262	104
RRS-60323	116	150
RRS-60152	116	140
RRS-60153	116	140

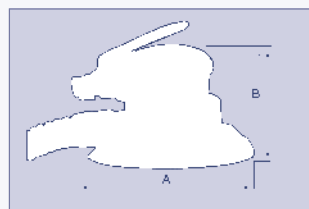

BELT SANDERS



RRG-3611*
RRG-3617K*



RRG-3621



RRG-3630

Type	Brand	Belt size mm	RPM	Power kW	Air cons. l/s	Weight kg	Inlet-thread	Hose diameter mm	Vibration m/s ²	Noise level dB(A)
RRG-3611*	RRI	10 x 330	20.000	0,28	6,7	0,75	PT 1/4"	10	0,6	80
RRG-3617K*	RRI	6/10 x 330	20.000	0,28	6,7	0,75	PT 1/4"	10	0,6	80
RRG-3621	RRI	20 x 520	18.000	0,34	8,7	1,40	PT 1/4"	10	2,5	79
RRG-3630	RRI	30 x 540	12.000	0,52	10,3	2,20	PT 1/4"	10	2	79

* The RRG-3617K is the same as model RRG-3611 however supplied as set. This set contains a sanding arm 6 x 330 and a sanding arm 10 x 330 mm (1 tool, 2 applications).

ACCESSORIES

Sanding belts & polishing pads



Sanding belt for 6 mm sanding arm

SSB60660	6 x 330 mm	Grain 60
SSB60680	6 x 330 mm	Grain 80
SSB606100	6 x 330 mm	Grain 100
SSB606120	6 x 330 mm	Grain 120
SSB606150	6 x 330 mm	Grain 150

Sanding belt for 10 mm sanding arm

SSB61060	10 x 330 mm	Grain 60
SSB61080	10 x 330 mm	Grain 80
SSB610100	10 x 330 mm	Grain 100
SSB610120	10 x 330 mm	Grain 120
SSB610150	10 x 330 mm	Grain 150

Sanding belt for 20 mm sanding arm

SSB62060	20 x 520 mm	Grain 60
SSB62080	20 x 520 mm	Grain 80
SSB620100	20 x 520 mm	Grain 100
SSB620120	20 x 520 mm	Grain 120
SSB620150	20 x 520 mm	Grain 150

Sanding belt for 30 mm sanding arm

SSB63060	30 x 540 mm	Grain 60
SSB63080	30 x 540 mm	Grain 80
SSB630100	30 x 540 mm	Grain 100
SSB630120	30 x 540 mm	Grain 120
SSB630150	30 x 540 mm	Grain 150

Polishing pads for RRS-60043K & RRS-60323

SA-75543VC*	Yellow pad 3 1/2": soft
SA-75653VC*	White pad 3 1/2": medium
SA-77213*	Bonnet 3 1/2"

* Supplied as standard

DIMENSIONS

Type	A mm	B mm
RRG-3611	50	265
RRG-3617K	50	265
RRG-3621	60	420
RRG-3630	60	490
RRS-60323	116	150
RRS-60152	116	140
RRS-60153	116	140

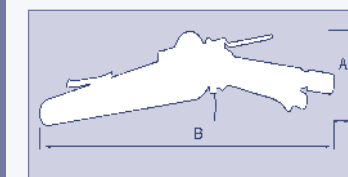

The RED ROOSTER belt sanders are suitable for nearly all materials, e.g. steel, aluminium, plastics and wood and for use as a de-burring method in difficult access applications. All belt sanders are equipped with safety handle and adjustable silencer.

CHISELS FOR AIR HAMMERS

Shank size 11 mm Hex / Ø 12,7 mm x 40 mm

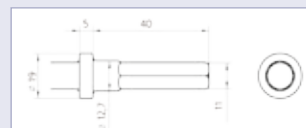

FOR HAMMERS:
 - RED ROOSTER RRH-2000
 - RED ROOSTER RRH-4309K
 - RED ROOSTER RRH-4312K
 - RED ROOSTER RRI-4021/4

Order number	Description	L (mm) total	B (mm)
CB51109165	Flat chisel	165	18
CB51109350	Wide flat chisel	350	18
CB51112180	Wide flat chisel	180	33
CB51104190	Wide flat chisel	190	33
CB51103185	Moil point	185	45
CB51115180	Slotting tool with carbide tip (8 mm)	180	-
CB51193180	Slotting tool with carbide tip (4 mm)	180	38
CB51193180-4	Slotting tool with carbide tip (6 mm)	180	38
CB51193180-6	Voegenbeitel hardmetaal (6 mm)	180	38

Shank size 12,7 mm square, with recess

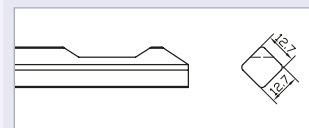

FOR HAMMERS:
 - RED ROOSTER RR-0315

Order number	Description	L (mm) total	B (mm)
BE15/1B	Flat, bent	113	19
BE15/1F	Flat chisel	114	19
BE15/1G	Wide flat chisel, bent	113	35
BE15/1W	Wide flat chisel	118	35
8160-1002-00-00	Flat, bent	113	26
CBMCOF25-150	Slotting tool with carbide tip	150	35

SHANK SIZE

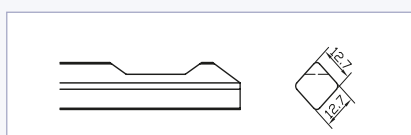

Type	A	B	C
RR-0315	16	12,7	28

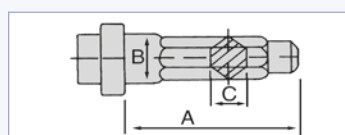

Type	A	B	C
RRH-2000	40	12,7	11
RRH-4309K	40	12,7	11
RRH-4312K	40	12,7	11
RRI-4021/4	40	12,7	11

HAMMERS



Type	Brand	Shank size mm	Bore diameter mm	Stroke mm	Blows p/min	J/Blow	Air cons. l/s	Weight kg	Inlet thread	Hose diameter mm	Vibration m/s ²	Noise level dB(A)
RRH-2000	RR	Ø11 x Ø12,7 x 40	17,4	42	5.000	4,5	8,4	1,5	PT 1/4"	10	8	88
RRI-40421/4	RRI	Ø11 x Ø12,7 x 40	18	30	4.500	3,5	10	2,2	PT 1/4"	10	3,5	88
RRH-4309K	RR	Ø11 x Ø12,7 x 40	19	67	3.200	13,4	1,8	1,7	PT 1/4"	10	2,2	95
RRH-4312K	RR	Ø11 x Ø12,7 x 40	19	89	2.100	24,5	1,8	1,8	PT 1/4"	10	2,6	95
RR-0315	RR	□12,7 x 16 x 28	25	32	4.000	7,4	3	2,6	PT 1/4"	6,5	9,4	93

HAMMER SETS



RRH-4309KSET1

- Hammer RRH-4210
- 5 chisels: for metal
- Quick change retainer



RRH-4309KSET2

- Hammer RRH-4210K
- 4 chisels: for concrete/stone
- Quick change retainer

AVAILABLE FROM 02-2017

DIMENSIONS

Type	A mm	B mm
RR-0315	320	43
RRH-2000	165	140
RRH-4309K	223	173
RRH-4312K	267	173
RRI-40421/4	255	100

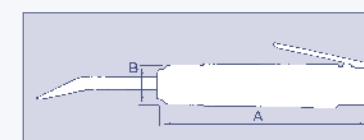
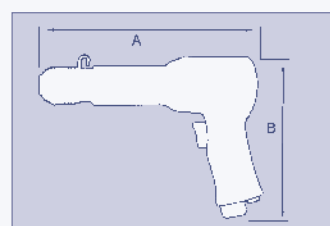

ACCESSORIES

Quick change chisel retainer

RRH-2000	PT-2311
----------	---------

Retainer rubber

RRH-2000	10219 RRH-2000	*
----------	----------------	---

* Supplied as standard

Retainer spring

RRH-2000	10219 RRH-2000	*
----------	----------------	---

* Supplied as standard

NEEDLE SCALERS



Type	Brand	Bore diameter mm	Stroke mm	Blows p/min	Air cons. l/s	Weight kg	Inlet-thread	Hose diameter mm	Vibration m/s ²	Noise level dB(A)
RR-0315NS	RR	25	32	4.000	6,6	2,6	PT 1/4"	6,5	9,4	93
RR-2110NS	RR	23,5	33	3.000	6,6	2,5	PT 1/4"	6,5	20	96
RRI-4006	RRI	23,5	34	3.000	2,6	2,6	PT 1/4"	6,5	17	90
RRI-4006VL ¹⁾²⁾	RRI	23,5	34	2.400	1,9	2,7	PT 1/4"	6,5	2,7	90
RRI-4007	RRI	30,5	30,5	2.500	3,3	4,3	PT 1/4"	6,5	12	91
RRI-4007VL ¹⁾²⁾	RRI	34,4	30,5	3.000	2,6	3,4	PT 1/4"	6,5	1,9	95
RRI-4008	RRI	33	35,5	2.100	4,8	5,9	PT 1/4"	6,5	13	90

¹⁾ Vibration reduced / ²⁾ Can also be used as air hammer

DIMENSIONS	Type	A mm	B mm
	RR-0315NS	415	45
	RR-2110NS	340	175
	RRI-4006	330	48
	RRI-4006VL	340	48
	RRI-4007	460	57
	RRI-4007VL	330	48
	RRI-4008	475	66

NEEDLEHOLDERS	Type	2 mm	3 mm	4 mm
	RR-0315NS	-	SG-0315NS-25*	-
	RR-2110NS	SG-2110NS-24	SG-2110NS-17*	-
	RRI-4006	218	217*	-
	RRI-4006VL	601.2020	601.2030*	-
	RRI-4007	330	314*	353
	RRI-4007VL	601.3020	601.3030*	601.3040
RRI-4008	-	414	453*	

* Supplied as standard

NEEDLE FOR TYPE	Needle for type	Number 2 mm	Number 3 mm	Number 4 mm
	RR-0315NS	-	19	-
	RR-2110NS	29	19	-
	RRI-4006	51	19	-
	RRI-4006VL	51	19	-
	RRI-4007	65	28	19
	RRI-4007VL	65	28	19
RRI-4008	-	49	35	

All needle scalers except RRI-4008 are supplied as standard with 3 mm needles, RRI-4008 is supplied with 4 mm needles.

NEEDLES	Order number	Ø	Model
	6203-0827-02-01	2 mm	Blunt, hardened steel
	6203-0827-03-01*	3 mm	Blunt, hardened steel
	6203-0827-03-02	3 mm	Chisel point, hardened steel
	6203-0827-03-03	3 mm	Copper-beryllium
	6203-0827-04-01	4 mm	Blunt, hardened steel

* Supplied as standard

SAWS



Chain saw

Type	Brand	Length sawblade inch	Max capacity mm	RPM ¹	Power kW	Air cons. l/s	Weight kg	Inlet-thread	Hose diameter mm	Vibration m/s ²	Noise level dB(A)
RRI-8560	RRI	14"	340	18.000	1,5	50	7,6	BSP 3/4"	19	< 2,5 m/s ²	98

Accessories for saws on page 22



Always use the tube spanner and chain for fixation of the tool!

Pipe saw

Type	Brand	Capacity steel Ø mm	Strokes p/min	Stroke mm	Power kW	Air cons. l/s	Weight kg	Inlet-thread	Hose diameter mm	Vibration m/s ²	Noise level dB(A)
RRI-8460	RRI	45-530	300	65	1,1	20	8	BSP 3/4"	19	1,7	82

Accessories for saws on page 22

Reciprocating saws

Type	Brand	Capacity steel mm	Capacity aluminium mm	Strokes min ⁻¹	Stroke mm	Power kW	Air cons. l/s	Weight kg	Inlet-thread	Hose diameter mm	Vibration m/s ²	Noise level dB(A)
RRJ-8205*	RR	10	12	5.000	25	0,25	2,8	0,96	PT 1/4"	6,5	3,5	79
RRJ-8210*	RR	3,1	3,9	9.500	10	0,25	2,8	0,51	PT 1/4"	6,5	3,5	78

* Standard supplied in set. Sawblades and universal air inlet joint are supplied as standard. / Accessories for saws on page 22

DIMENSIONS	Type	A mm	B mm	C mm	D mm
	RRJ-8205	367	65	-	-
	RRJ-8210	365	80	-	-
	RRI-8460	460	537	240	-
	RRI-8560	340	650	20	200

SAWS

ACCESSORIES

Sawblades for the RRJ-8210

Description	Order number	Teeth
5-pack sawblades: 74 mm	31418-5	18 teeth/inch St37, V2A, wood, plastics, metal plate up to 2,5 mm
5-pack sawblades: 74 mm	31442-5	24 teeth/inch St37, V2A, aluminium, metal plate up to 2 mm
5-pack sawblades: 74 mm	31432-5	32 teeth/inch, St37, V2A, aluminium, metal plate up to 1 mm
Files	8210-501-00	5 mm, square
5 mm	8210-502-00	5 mm, round
length: 74 mm	8210-503-00	5 mm, half-round
	8210-504-00	5 mm, triangle

Sawblades for the RRJ-8205

Description	Order number	Teeth
5-pack sawblades	8205-518-00	18-teeth
length: 140 mm	8205-524-00	24-teeth

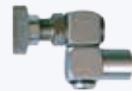

Swivel Joint for the RRJ-8205 & RRJ-8210

Description	Order number
Universal Swivel Joint 1/4"	922A18

Pipe clamps & sawblades for the RRI-8460

Description	Order number	Dimensions	Teeth
Pipe clamp	8460-200-00	6"	
	8460-201-01	12"	
	8460-205-00	20"	
Extension chain	8460-201-50		
HSS-sawblades	Z22-10	200 x 25 x 1,5	22 teeth/inch
	Z22-6	300 x 25 x 1,5	16 teeth/inch
	Z22-7	400 x 25 x 1,5	16 teeth/inch
	Z22-72	500 x 28 x 2	14 teeth/inch
	Z22-73	600 x 28 x 2	14 teeth/inch
	Z22-75	770 x 28 x 2	12 teeth/inch
	Z22-31	300 x 25 x 1,5	12 teeth/inch
	Z22-30	530 x 28 x 1,5	12 teeth/inch
	Z22-37	940 x 32 x 2	12 teeth/inch
	Z22-9	200 x 25 x 1,5	8 teeth/inch
	Z22-29	400 x 25 x 1,5	8 teeth/inch
	Z22-74	600 x 28 x 2	8 teeth/inch
HSS-sawblade	Z22CT-06	300 x 25 x 2	16 teeth/inch
Sawblades tungsten carbide coating	2CT-72	500 x 32 x 2,5	-
	2CT-73	600 x 32 x 2,5	-

VARIOUS TOOLS

ACCESSORIES

For type	Accessory	Order number	*
RRI-4010	Nose piece 3,2 mm	10416-1	*
	Nose piece 4,0 mm	10416-2	*
	Nose piece 4,8 mm	10416-3	*
	Bottle for spent rivets	10448	*
	Wrench	10447	*
RRI-4011	Nose piece 2,4 mm	14463	*
	Nose piece 3,2 mm	14464	*
	Nose piece 4,0 mm	14465	*
	Nose piece 4,8 mm	14466	*
	Nose piece 6,4 mm	14468	*
	Rivet deflector	14470	*
	Rivet collector (cloth)	612903	
	Set key	14499	

* Supplied as standard

For type	Accessory	Order number	*
RRI-9010	Engraving needle, fine	2-01-011-90	
	Engraving needle, medium	2-01-011-91	*
	Engraving needle, coarse	2-01-011-92	

* Supplied as standard

DIMENSIONS

Type	A mm	B mm	C mm	D mm
RRB-280	225	85	28	50
RRI-4010	159	299	-	-
RRI-4011	198	315	-	-
RRI-9010	160	-	-	-
RRP-203	268	135	-	-
RRI-21930	80	250	-	-
RR-476	195	79	-	-

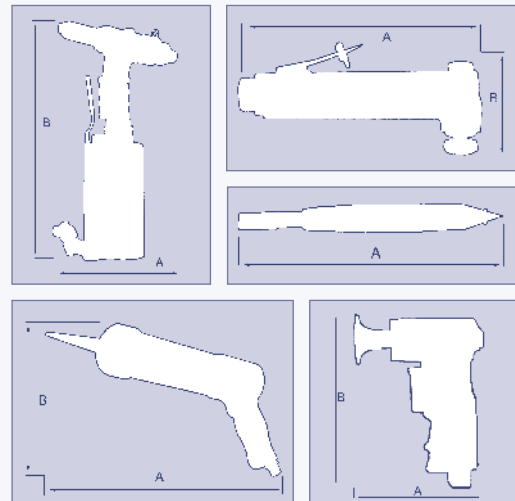

VARIOUS TOOLS



Riveters

Type	Brand	Traction kg	Capacity rivets diameter	Air cons. l/stroke	Weight kg	Inlet-thread	Hose diameter mm	Vibration m/s ²	Noise level dB(A)
RRI-4010	RRI	900	until 4,8	1,15	1,5	PT 1/4"	6	1,5	76
RRI-4011	RRI	1.045	tot 6,4	1,80	2	PT 1/4"	6	0,4	76

For accessories see page on the left

Engraving pen

Type	Brand	Needle diameter mm	Strokes p/min	Air cons. l/sec	Weight kg	Inlet-thread	Hose diameter mm	Vibration m/s ²	Noise level dB(A)
RRI-9010	RRI	1,7	36.000	0,5	0,25	R 1/4"	4	0,7	62

For accessories see page on the left

Caulking gun

Type	Brand	Tube Ø x mm	Working pressure bar	Air cons. l/sec	Weight kg	Inlet-thread	Hose diameter mm	Vibration m/s ²	noise level dB(A)
RRP-203	RR	50 x 215	2-4	-	1,1	PT 1/4"	6,5	-	-

Blow guns

Type	Brand	Air cons. l/sec	Weight kg	Inlet-thread	Hose diameter mm
RRI-21930	RRI	5	0,2	PT 1/4"	6,5

Wire brush sander

Type	Brand	Pad size mm	RPM	Power kW	Spindle	Air cons. l/s	Weight kg	Inlet-thread	Hose diameter mm	Vibration m/s ²	Noise level dB(A)
RRB-280	RRI	80 ¹⁾	8.000	0,45	M14 x 2 ²⁾	9,6	1,5	PT 1/4"	10	9	80

¹⁾ Size wire brush (supplied without wire brushes) / ²⁾ Spindle stainless steel

ACTION IMPACT SOCKET SETS

Impact socket set, deep, 85 mm

DO611260501

Contents:
5 impact sockets with plastic stop and sleeve
white 15 mm, blue 17 mm, yellow 19 mm, red 21 mm, green 22 mm

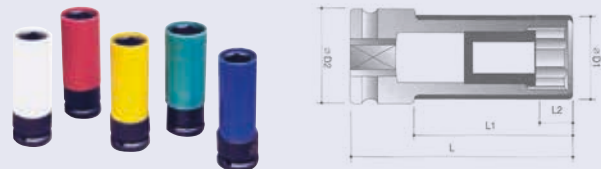

Type	SW mm	Colour	D1 mm	D2 mm	L mm	L1 mm	L2 mm
DO61126015	15	white	24	30	80	60	15
DO61126017	17	blue	26	30	85	60	13
DO61126019	19	yellow	28	30	85	60	18
DO61126021	21	red	31	30	85	60	14
DO61126022	22	green	31,5	30	85	60	17

For optimum protection of aluminum rims, impact sockets with plastic stop and sleeve in five different colours for easy identification.

Impact socket set, extra long, 130 mm

DO61120310

Contents:
3 impact sockets with plastic stop and sleeve
blue 17 mm - yellow 19 mm - red 21 mm

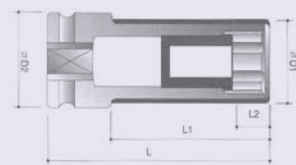

Type	A/F mm	Colour	D1 mm	D2 mm	L mm	L1 mm	L2 mm
DO6112J017	17	blue	26	25	130	87	24
DO6112J019	19	yellow	28	30	130	87	24
DO6112J021	21	red	30	30	130	87	24
DO6112J022	22	green	31,5	30	130	87	24

For optimum protection of aluminum rims, impact sockets with plastic stop and sleeve in four different colours for easy identification.

Impact socket for Mercedes

DO6112P017

Wheel nut impact socket for special Mercedes wheel bolts with rotating plastic sleeve and stop for protection of light alloy wheels.



The Special Impact Socket is suitable for Mercedes C-Class / GLK (W204), E-Class (W211, W212, W207), SLK (W172), M-Class (W164, W166), CL-Class (W216), S-Class (W221, W222) and Maybach.

Special socket set for wheel lug nut

DO0012-0-286



Contents:
7 pcs of lug nut removal sockets,
17 - 18,5 - 20 - 21,5 - 23 - 24,5 - 26 mm

Application wheel lock nut removal sockets

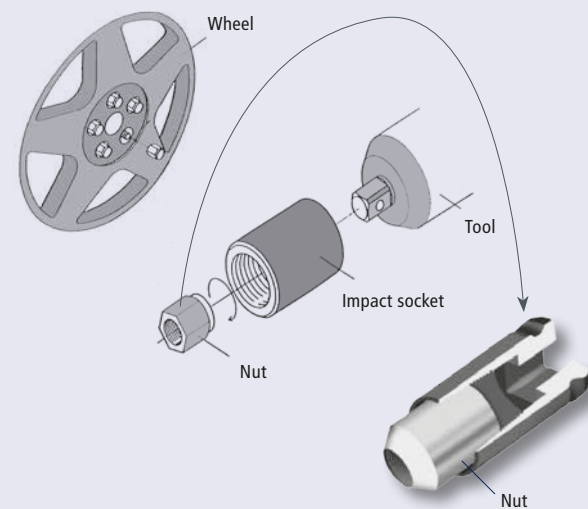

For removal of wheel lock nuts when special key is lost or not supplied upon service and for removal of the wheel nut when hexagon is damaged.

ACTION IMPACT SOCKET SETS

Impact socket set

DO0038-0-010

Contents:
10 impact sockets, 6-point
9 - 10 - 11 - 12 - 13 - 14 - 15 - 16 - 17 - 19 mm



Impact socket set

DO605121301

Contents:
13 impact sockets, 6-point deep, deep
7 - 8 - 9 - 10 - 11 - 12 - 13 - 14 - 15 - 16 - 17 - 18 - 19 mm



Impact socket set magnetic reducers

DO698800401

Contents:
4 pcs. magnetic sleeve insert adaptors
Magnetic reducing sleeve 1/4" F x 3/8" M
Magnetic reducing sleeve 3/8" F x 1/2" M
Magnetic reducing sleeve 1/2" F x 3/4" M
Magnetic reducing sleeve 3/4" F x 1" M



To enable temporary use of larger impact sockets on smaller machines. The magnet ensures that the adaptor stays connected to the socket. This set is ideal for the toolbox of every service engineer taking care of service and repair of large equipment on location.

In this brochure only our impact sockets sets are displayed. For a complete overview of our impact socket range please ask for our impact sockets brochure (see back cover).



SMC AIR TREATMENT



AC-series - combination of AF (filter), AR (regulator), AL (lubricator) and pressure gauge

Type	Brand	Port size	NI/min	Filter micron	Working pres. (bar)	Bowl	Bowl with bajonet connection ¹⁾
AC20-F02E-B	SMC	1/4"	500	5	0,05 - 0,85	Polycarbonate	o
AC30-F03E-B	SMC	3/8"	2.000	5	0,05 - 0,85	Polycarbonate	s
AC40-F03E-B	SMC	3/8"	4.000	5	0,05 - 0,85	Polycarbonate	s
AC40-F04E-B	SMC	1/2"	4.000	5	0,05 - 0,85	Polycarbonate	s
AC40-F06E-B	SMC	3/4"	4.500	5	0,05 - 0,85	Polycarbonate	s
AC50-F06E-B	SMC	3/4"	5.000	5	0,05 - 0,85	Polycarbonate	s
AC50-F10E-B	SMC	1"	5.000	5	0,05 - 0,85	Polycarbonate	s
AC60-F10E-B	SMC	1"	7.000	5	0,05 - 0,85	Polycarbonate	s

¹⁾ o = optional, s = standard / Max. supply pressure: 1,5 MPa / Max. working pressure: 1,0 MPa / Temperature working area: -5 to 60° C.



AC-B

AC-series - combination of AW (filter, regulator combination), AL (lubricator) and pressure gauge

Type	Brand	Port size	NI/min	Filter micron	Working pres. (bar)	Bowl	Bowl with bajonet connection ¹⁾
AC20A-F02E-B	SMC	1/4"	500	5	0,05 - 0,85	Polycarbonate	o
AC30A-F03E-B	SMC	3/8"	1.700	5	0,05 - 0,85	Polycarbonate	s
AC40A-F04E-B	SMC	1/2"	3.000	5	0,05 - 0,85	Polycarbonate	s
AC50A-F06E-B	SMC	3/4"	3.500	5	0,05 - 0,85	Polycarbonate	s

¹⁾ o = optional, s = standard / Max. supply pressure: 1,5 MPa / Max. working pressure: 1,0 MPa / Temperature working area: -5 to 60° C.



AC..A-B

A wider range of SMC air treatment products can be found in our Air Tool catalogue.

OTHER BROCHURES OF RAMI YOKOTA BV



AIR TOOLS

Product range TOKU, YOKOTA, RED ROOSTER, ACTION & SMC

Content:
Impact wrenches, Impulse wrenches, Ratchet wrenches, Impact sockets, Screwdrivers, Drills, Grinders & sanders, Hammers, Needlescalers, Saws, Pumps, Air chain hoists, Spring balancers, Air treatment equipment.

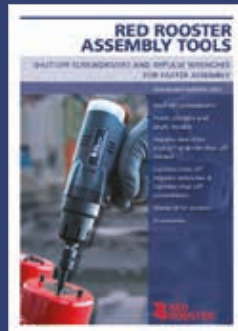

RED ROOSTER ASSEMBLY TOOLS

Shut-off screwdrivers and impulse wrenches for faster assembly

Content:
Shut-off screwdrivers & Impulse wrenches (shut-off and non shut-off models), Cordless shut-off screwdrivers & Cordless shut-off impulse wrenches, Sleeve drive sockets & Accessories.



RED ROOSTER AIR CHAIN HOISTS

Air Chain Hoists 125 kg - 100 tonnes

Content:
Air Chain Hoists 0,125 /100 tonnes, Compact hoists, Mini hoists, Air chain hoists, Trolleys, Explosion proof, Accessories.



ACTION IMPACT SOCKETS

Impact sockets for optimal performance and security

Content:
Normal/Long, Magnetic/Torx®, Hex Head/12-Point, Surface Drive/Thin wall, Universal joints, Sleeve drive, Impact Socket Sets, Torque/Adapters, Extension Bars, etc.